

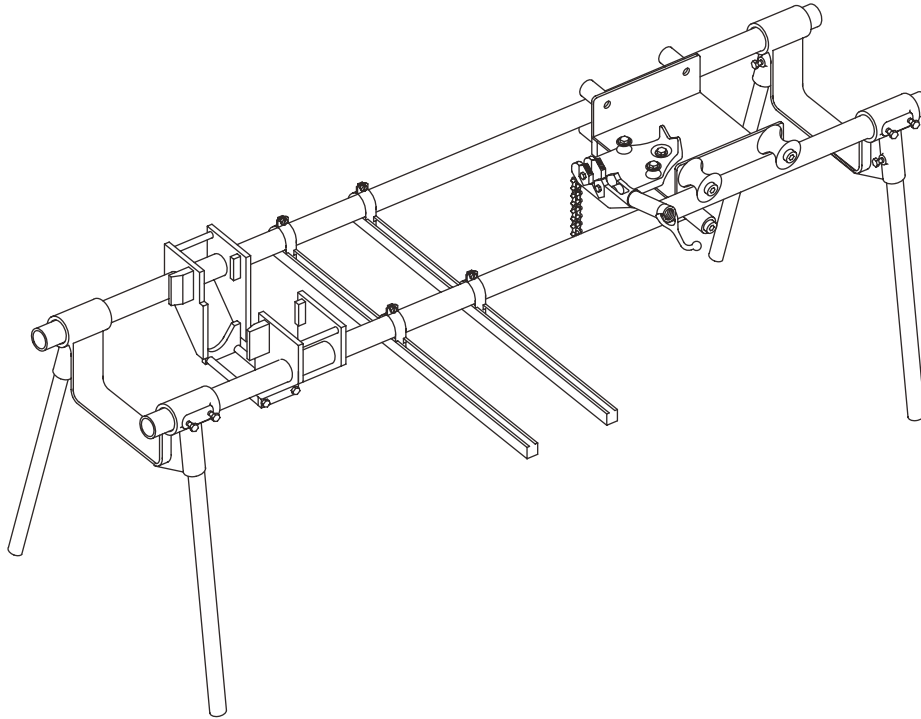

# ***Current Tools***

**FOR THE PROFESSIONAL ELECTRICIAN**

**Current Tools™ Model 281 Bending Table  
for use with Greenlee® Model 881 and  
881 CAMTRACK® Benders \***



## **Assembly, Operating, Safety and Parts Manual**



**Read and understand this material before assembling or operating the 281 Bending Table. Failure to understand how to safely assemble and operate this equipment may result in serious injury or death.**



**Read and understand the bender manufacturer's operating and safety instructions before attaching to or operating with the 281 Bending Table. Failure to do so may result in serious injury or death.**

This manual is free of charge. All personnel who assemble or operate this equipment should have a copy of these manuals and read and understand their contents. To request a copy, call or write to the address below.

**CURRENT TOOLS • P. O. BOX 17026 GREENVILLE, SC 29606  
800.230.5421 or 864.244.1201 • FAX 864.244.5860**

\* Greenlee® and CAMTRACK® are registered trademarks of Greenlee/Texttron, which has no affiliation with Current Tools. [www.currenttools.com](http://www.currenttools.com)

## **TABLE OF CONTENTS — 281 Bending Table**

<b><i>Safety Information</i></b> .....	<b>2</b>
<b><i>Components</i></b> .....	<b>3</b>
<b><i>Assembly Instructions</i></b> .....	<b>3 – 7</b>
<b><i>Pump Mounting Options</i></b> .....	<b>6</b>
<b><i>Exploded View</i></b> .....	<b>8</b>
<b><i>Parts List</i></b> .....	<b>9</b>

### — RETAIN SAFETY INFORMATION —



This manual should be read and understood by all personnel who assemble or operate this Bending Table. Failure to understand how to safely assemble and operate this unit could result in serious injury or death. This Bending Table should only be operated by qualified personnel.

#### **WARNING**

This unit is intended to be used with Greenlee® Model 881 and 881 CAM TRACK® benders.\*

Read and understand the bender manufacturer's operating and safety instructions before attaching to or operating with the 281 Bending Table. Failure to do so may result in serious injury or death.

## **IMPORTANT SAFETY INFORMATION**

Follow **ALL** safety information provided by the bender manufacturer.

- DO NOT operate in wet or damp locations. DO NOT expose to rain.
- DO NOT operate in an explosive atmosphere.
- ALWAYS set-up bending table on a firm, level surface.
- Keep all body parts, hair, loose clothing, etc. away from rotating parts and pinch points.
- ALWAYS wear eye protection.
- DO NOT alter the bending table.

#### **WARNING**

Never allow the carriage with vise to contact the pump mounting brackets or any component of the bender or bending table during a bend.

- All pins, clips, bolts, etc. should be engaged and rechecked before any bending has begun.
- When using an electric pump, be sure to unplug pump before servicing and when not in use. Also, inspect hoses and power cords before use.
- Only the operator should be in the work area.
- Keep the work area clean.

\* Greenlee® and CAMTRACK® are registered trademarks of Greenlee/Texttron, which has no affiliation with Current Tools.

## COMPONENTS — 281 Bending Table

For use with Greenlee® Model 881 and 881 CAM TRACK® benders.\*

KEY	NO.	DESCRIPTION	QUANTITY
1	281-1	Carriage with vise	1
2	281-2	Bender mount unit	1
3	281-3	Ram positioning unit	1
4	280-5	Leg support	2
5	280-6	Legs	4
6	280-7	Magnetic protractor	1
7	281-4	Pump mounting brackets	4
8	281-5	Conduit clamps	4
9	281-6	Pump mounting track	2
10	281-7	90° fitting	1
	104	Storage Box (not shown)	1

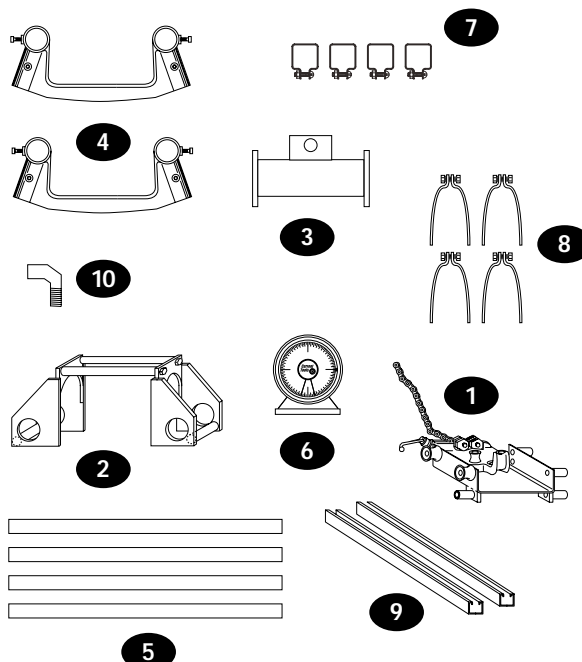

**NOTE:** 2 each 10' lengths of 2" rigid conduit used as the table supports are to be supplied by the user.

## ASSEMBLY INSTRUCTIONS

Insert two of the legs into the leg support as shown in *figure 1* and tighten the bolts to hold the legs in place. Repeat for second leg support.

Insert the ends of the two 10' pieces of 2" rigid conduit (supplied by the user) into one leg support assembly and tighten the two bolts on each side. See *figure 1*.

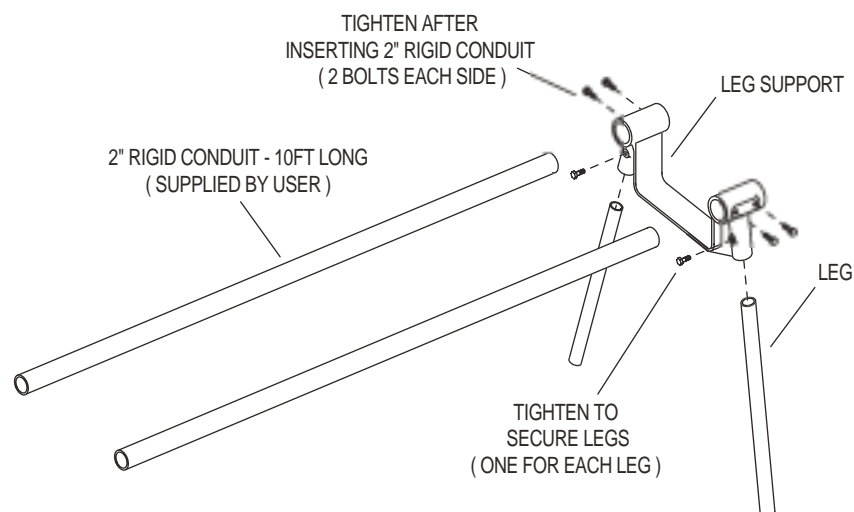

FIGURE 1

continued on next 4 pages . . .

\* Greenlee® and CAMTRACK® are registered trademarks of Greenlee/Texttron, which has no affiliation with Current Tools.

## ASSEMBLY INSTRUCTIONS continued . . .

Next, slide the carriage with vise onto the conduit as shown in *figure 2*. The chain side of the vise should face away from the one leg support assembly you have completed.

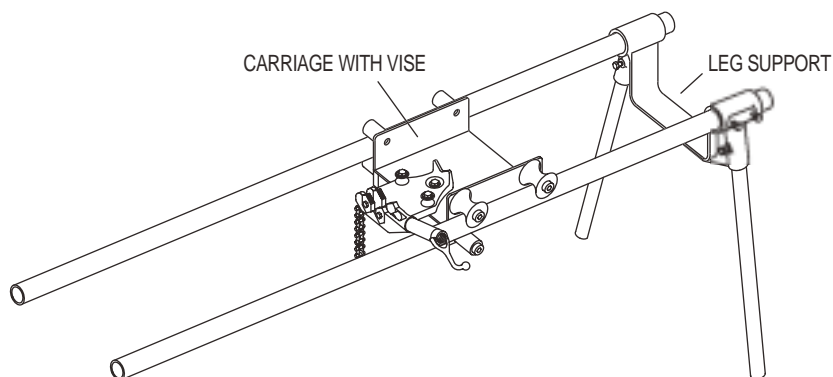

FIGURE 2

---

Now slide the bender mounting unit onto the two 10' lengths of rigid conduit. Be sure that the follow bar guide "ears" point away from the carriage with vise. See *figure 3*.

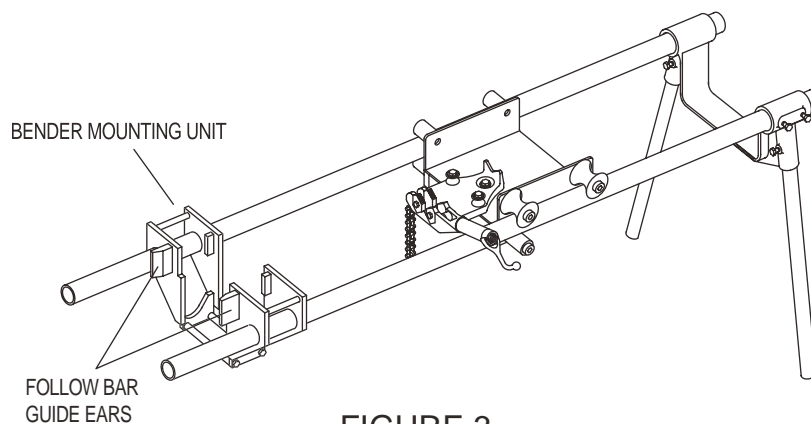

FIGURE 3

*continued on next 3 pages . . .*

## ASSEMBLY INSTRUCTIONS continued . . .

Insert the two 10' lengths of conduit into the remaining leg support assembly and tighten the four bolts against the conduit. *See figure 4.*

Place the bender mounting unit 15 inches away from the leg support you have just completed and tighten the 2 bolts on the bottom of the bender mount unit against the two 10' lengths of rigid conduit to keep the bender mount unit in place. *See figure 4.*

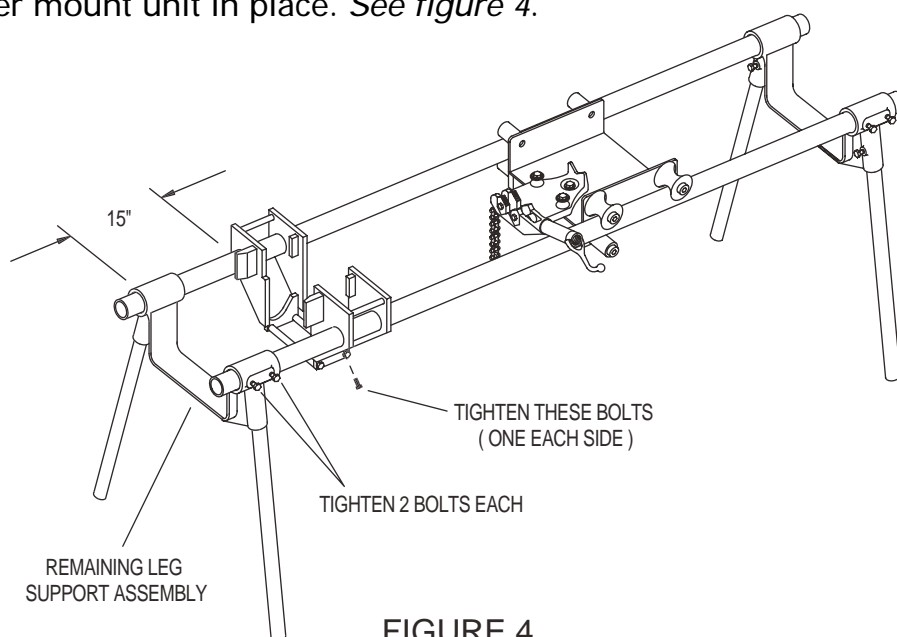

FIGURE 4

Next, attach the two pump mounting brackets to the bending table with the 4 conduit clamps as shown in *figure 5*. DO NOT tighten these firmly at this time.

**— IMPORTANT —**  
**LEVEL THE TABLE**  
**BEFORE CONTINUING.**

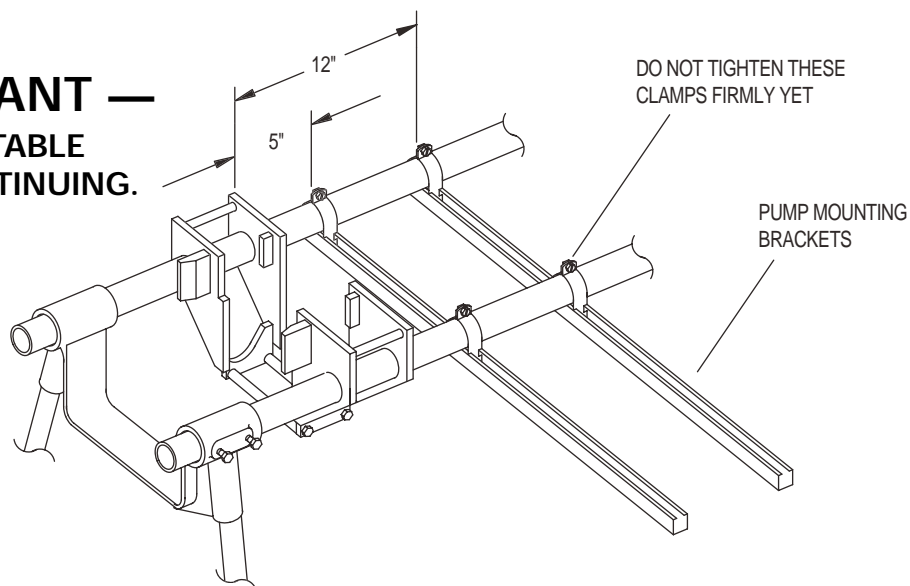

FIGURE 5

*continued on next 2 pages . . .*

## ASSEMBLY INSTRUCTIONS continued . . .

Attach the pump mounting brackets to the 4 corner holes of the pump. *See drawings below for pump mounting bracket installation.* Place the pump with brackets attached onto the pump mounting track. Secure the pump mounting brackets in place by tightening the bolts on the bottom of each pump mounting bracket. Next, firmly tighten the conduit clamps.

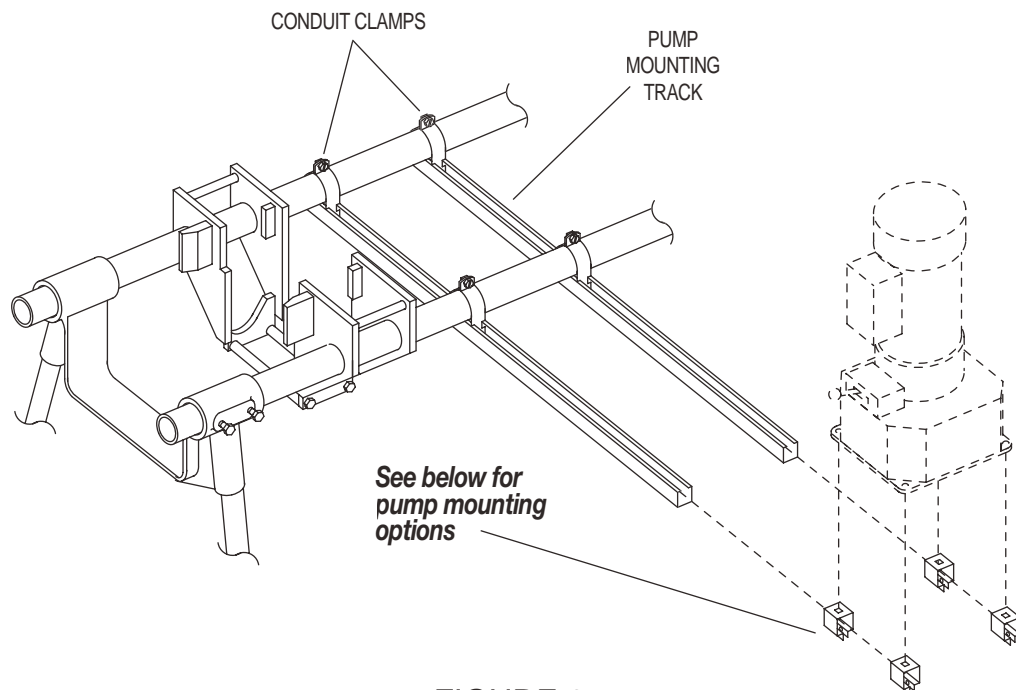
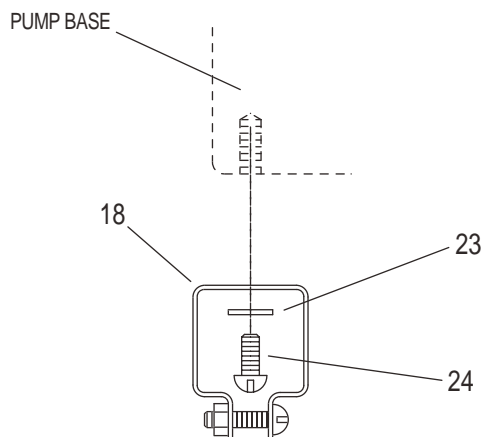
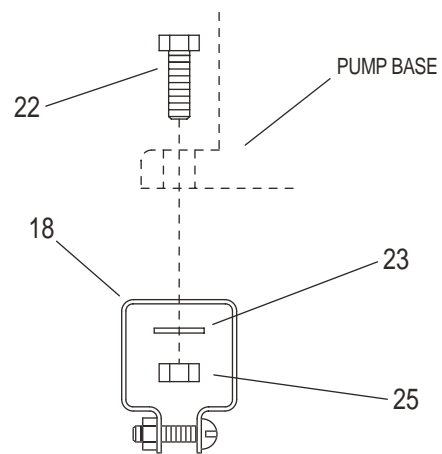

FIGURE 6

## PUMP MOUNTING OPTIONS



**BLIND HOLE STYLE**



**THROUGH HOLE STYLE**

Refer to Parts List (Page 10)

continued on next page . . .

## ASSEMBLY INSTRUCTIONS continued . . .

Remove quick coupling from top of ram and replace with 90° fitting. Then screw quick coupling into 90° fitting.

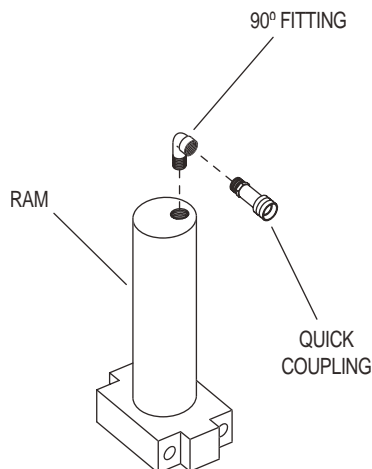

FIGURE 7

### — IMPORTANT —

AT THIS POINT YOU MUST REFER TO THE  
GREENLEE® MODEL 881 OR 881 CAM TRACK® \*  
INSTRUCTION MANUAL FOR PROPER  
ASSEMBLY AND OPERATION OF THE BENDER  
WITH A BENDING TABLE.

\* Greenlee® and CAM TRACK® are registered trademarks of Greenlee/Textron, which has no affiliation with Current Tools.

SET – UP (*Less pump and bender*)

## 281 BENDING TABLE

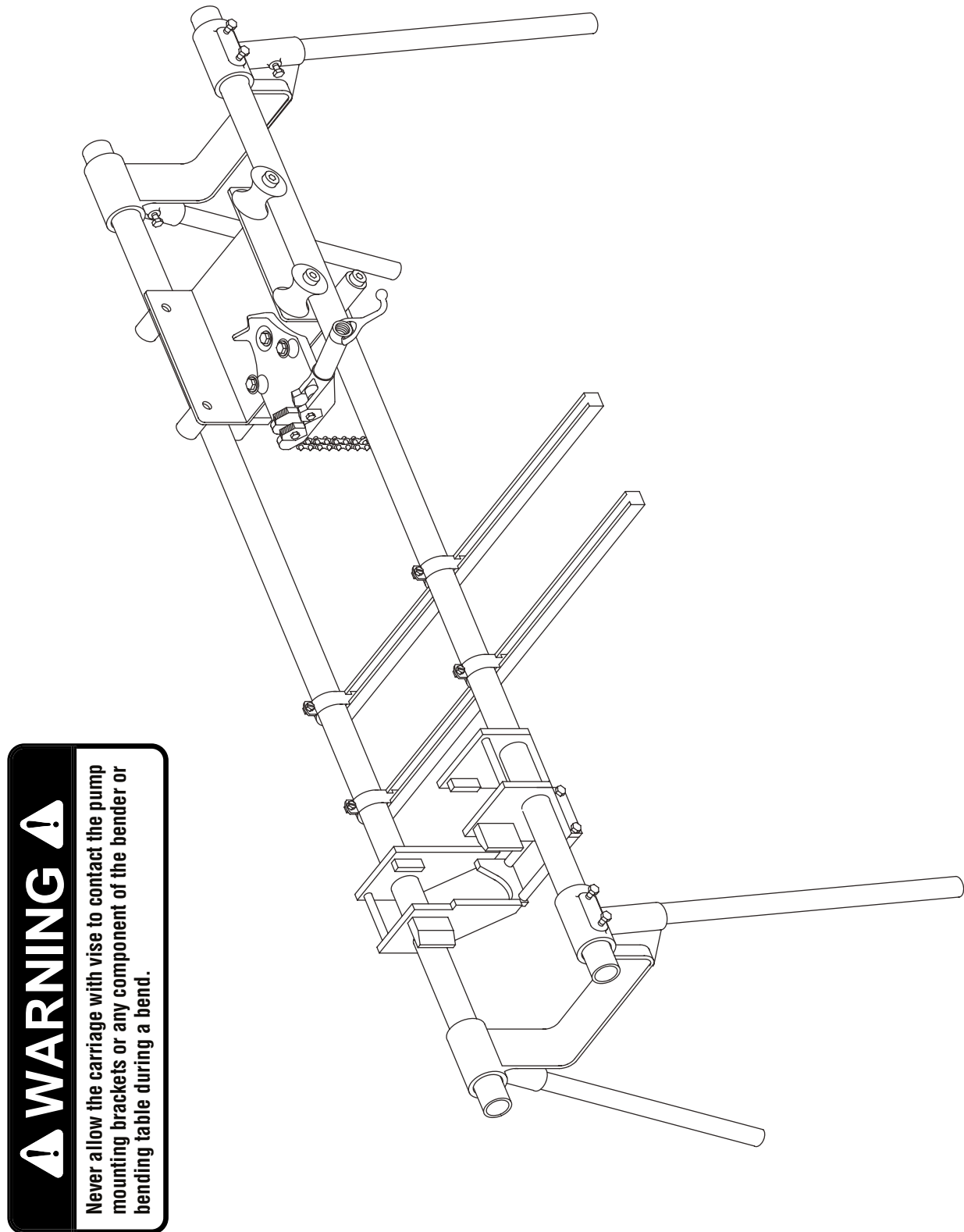
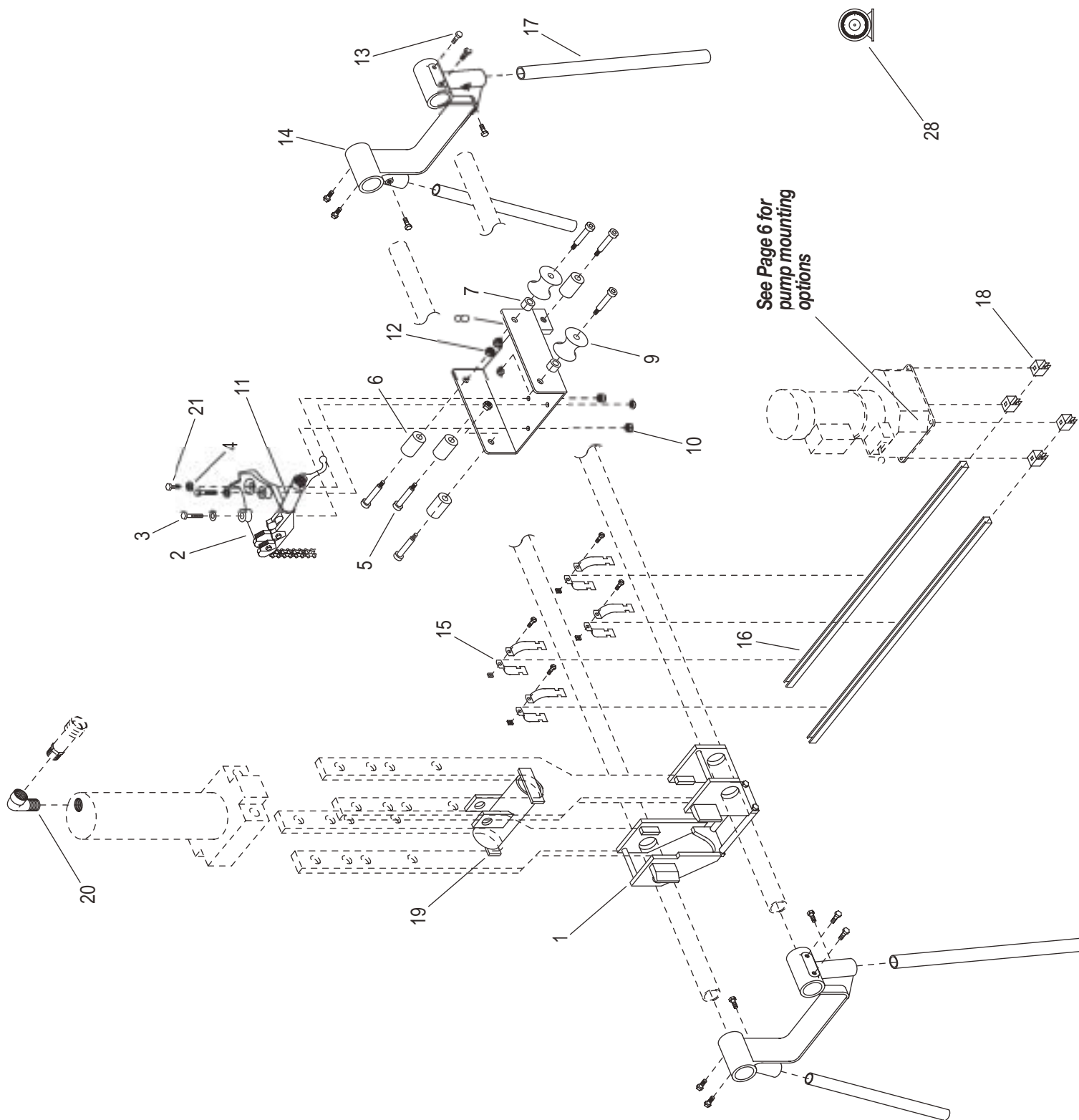

FIGURE 8



EXPLODED VIEW

# 281 BENDING TABLE





## PARTS LIST — 281 Bending Table

<u>ITEM#</u>	<u>PARTS#</u>	<u>QTY</u>	<u>DESCRIPTION</u>
1.....	281-2.....	1.....	BENDER MOUNTING UNIT
2.....	281-1G.....	1.....	WISE UNIT
3.....	281-1E.....	2.....	1/2-13 X 3 HEX HEAD CAP SCREW
4.....	281-1K.....	3.....	1/2 USS FLAT WASHER
5.....	281-1D.....	6.....	3/4 X 2 3/4 SOCKET HEAD SHOULDER BOLT
6.....	280-1B.....	4.....	FLAT ROLLER
7.....	280-2E.....	2.....	SPACER
8.....	280-1C.....	1.....	CARRIAGE UNIT
9.....	280-1A.....	2.....	CUPPED ROLLER
10.....	281-1J.....	3.....	NYLON INSERT LOCK NUT
11.....	281-1L.....	1.....	HANDLE SPACER
12.....	281-1I.....	4.....	5/8-11 THIN NYL. INSERT LOCK NUT
13.....	281-2B.....	12.....	1/2-13 X 1 1/4" HEX HEAD CAP SCREW
14.....	280-5A.....	2.....	LEG SUPPORT
15.....	281-5.....	4.....	CONDUIT CLAMPS
16.....	281-6.....	2.....	PUMP MOUNTING TRACK
17.....	280-6.....	4.....	LEGS
18.....	281-4D.....	4.....	PUMP MOUNTING BRACKET
19.....	281-3.....	1.....	RAM POSITIONING UNIT
20.....	281-7.....	1.....	90° FITTING
21.....	281-1F.....	1.....	1/2-13 X 1 1/2 HEX HEAD CAP SCREW
22.....	281-4F.....	4.....	1/4-20 X 1 HEX HEAD CAP SCREW
23.....	450-14G.....	4.....	1/4" LOCK WASHER
24.....	281-4E.....	4.....	1/4-20 X 1/2 RND. HEAD MACH. SCREW
25.....	450-14C.....	4.....	1/4-20 HEX NUT
26.....	281-1H.....	1.....	CARRIAGE UNIT DECAL ( <i>not shown</i> )
27.....	BX-1A.....	1.....	DECAL-BOX ( <i>not shown</i> )
28.....	104.....	1.....	BOX ( <i>not shown</i> )
29.....	280-7.....	1.....	PROTRACTOR